

**vario**  
*Depot*™

The perfect  
indoor/outdoor  
solution for all  
your stand alone  
delivery and  
collection needs



Florence also offers the vario™ Shelter  
and vario™ Express mail park kiosks



**4C Mailbox Suite Options**



vario™ Depot - small in dark bronze powder coat finish with versatile™ 4C Suite D mailbox in silver speck powder coat finish

**Trash/Recycling Bin Options**

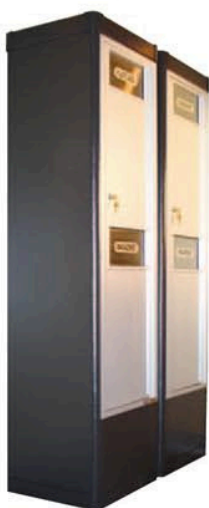

vario™ Depot - large in dark bronze powder coat finish with versatile™ 4C Suite F Trash / Recycling Bins in silver speck powder coat finish

**vario Depot™**

- Pre-engineered mail stand kit comes complete with all necessary hardware, excluding anchor system
- All aluminum, corrosion resistant construction available in ten architectural powder coat finishes
- Designed exclusively to accommodate USPS Approved Florence versatile™ 4C mailbox or trash/recycling bin modules (sold separately)
- Depot design ensures Florence versatile™ 4C mailbox suite modules comply with USPS STD-4C installation requirements
- The perfect indoor/outdoor solution for all your stand alone delivery and collection needs – no wall space required

**Color Options**

Customize your vario™ Depot mail stands with ten different architectural powder coat finishes

<b>Dark Bronze</b> PMS Black 7C	<b>Black</b> PMS Black 6C	<b>Postal Grey</b> PMS 413C	<b>Silver Speck</b> PMS 877C	<b>Antique Copper*</b> PMS 876C
<b>Sandstone</b> PMS 75017C	<b>Blonde Gold</b> PMS 7536C	<b>White</b> PMS White	<b>Forest Green</b> PMS 3308C	<b>Antique Bronze*</b> PMS 8622C

\* NEW Colors

**vario™ Depot - small**

Installed Stand Height	4'-6 1/4"
Installed Stand Depth	1'-6 1/8"
Installed Stand Width (single-wide)	1'-8 1/4"
Installed Stand Width (double-wide)	2'-10 5/16"
Maximum Mailboxes	9
Minimum Parcel Lockers (1:10 ratio)	0
4C Suite Compatibility	B, D, I

**vario™ Depot - medium**

Installed Stand Height	5'-10 1/2"
Installed Stand Depth	1'-6 1/8"
Installed Stand Width (single-wide)	1'-8 1/4"
Installed Stand Width (double-wide)	2'-10 5/16"
Maximum Mailboxes	15
Minimum Parcel Lockers (1:10 ratio)	1
4C Suite Compatibility	A, E, H

**vario™ Depot - large**

Installed Stand Height	6'-1 5/16"
Installed Stand Depth	1'-6 1/8"
Installed Stand Width (single-wide)	1'-8 1/4"
Installed Stand Width (double-wide)	2'-10 5/16"
Maximum Mailboxes	20
Minimum Parcel Lockers (1:10 ratio)	2
4C Suite Compatibility	C, F, G

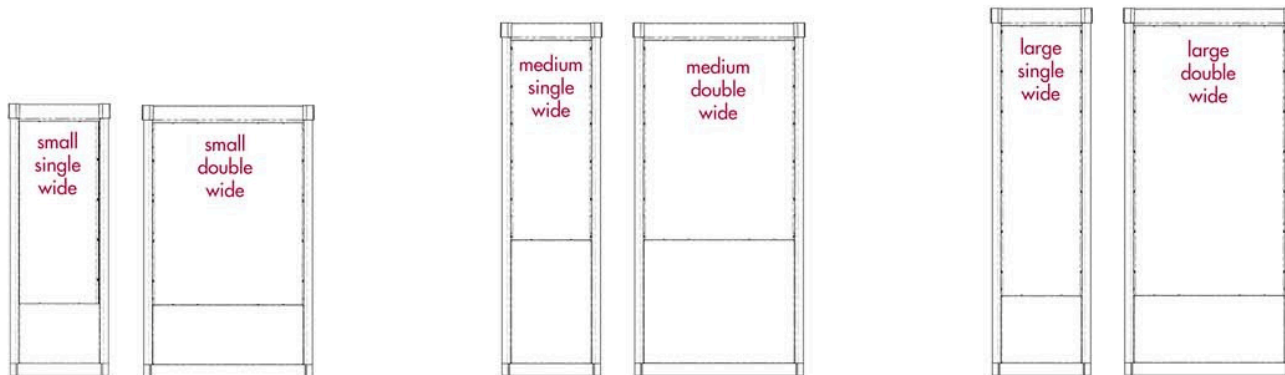

A GIBRALTAR INDUSTRIES COMPANY

[www.MailboxWorks.com](http://www.MailboxWorks.com)

800.824.9985