

REAR VIEW

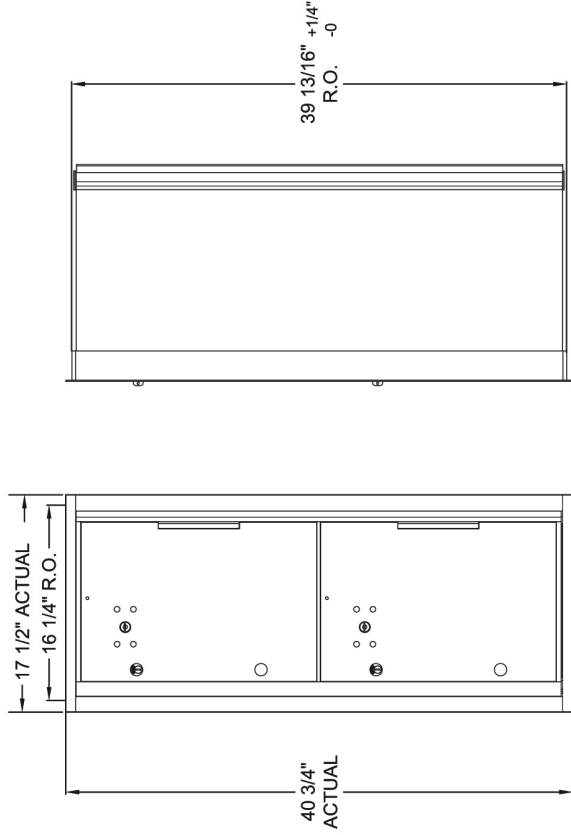

INSTALLATION EXAMPLE

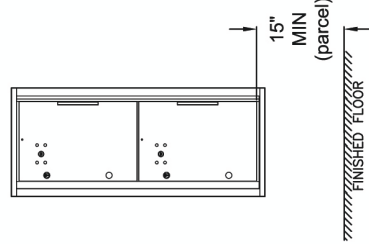

Rear load door detail:

1. Hinge rear door panels constructed of heavy-gauge steel powder coated postal grey.
2. Latch mechanism secures rear doors - this is the USPS approved standard design.
3. No USPS arrow lock required for rear doors.

Installation requirements specified in USPS STD-4C include:

1. At least one customer compartment shall be positioned less than 48" from the finished floor.
2. No parcel locker (interior bottom shelf) shall be positioned less than 15" from finished floor.
3. No patron (tenant) lock shall be positioned more than 67" above finished floor.
4. No customer compartment (interior bottom shelf) shall be positioned less than 28" from finished floor.

the Mailbox Works
since 1988
www.MailboxWorks.com
800.924.9985
info@mailboxworks.com

PRODUCT SERIES: VERSATILE™ 4C SUITE H
 REAR LOAD

by Auth Florence

MODEL	4CH110R	REV	
SCALE	NONE	DATE	3/25/08
DRAWING NUMBER	4CH10RCS	DRAWN BY	SAD
			1 OF 1