

**INSTALLATION
EXAMPLE**

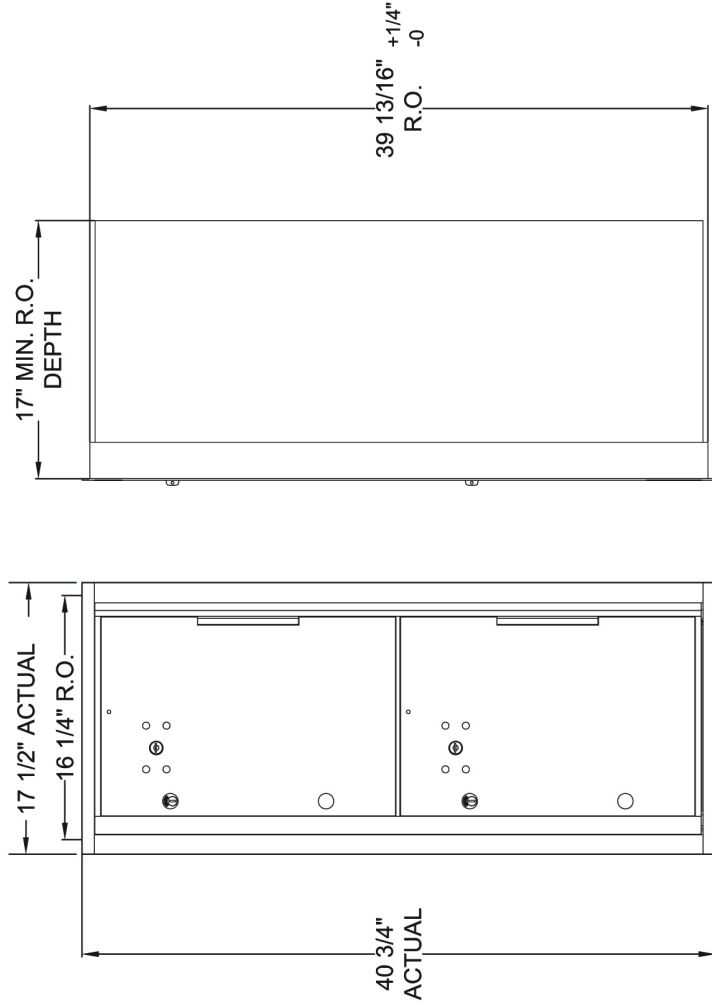
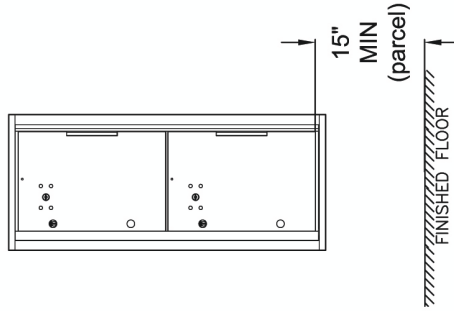

Installation requirements specified in USPS STD-4C include:

1. At least one customer compartment shall be positioned less than 48" from the finished floor.
2. No parcel locker (interior bottom shelf) shall be positioned less than 15" from finished floor.
3. No patron (tenant) lock shall be positioned more than 67" above finished floor.
4. No customer compartment (interior bottom shelf) shall be positioned less than 28" from finished floor.
5. The USPS Arrow lock shall be positioned 36"-48" above finished floor.

by Auth Florence

PRODUCT SERIES: VERSATILE™ 4C SUITE H
FRONT LOAD

MODEL	4CHT10	REV	-
SCALE	NONE	DATE	3/25/08
DRAWING NUMBER	4CHT0CS	DRAWN BY	SAD
		SHEET	1 OF 1

The Mailbox Works
SINCE 1989
www.MailboxWorks.com
800.824.9985
info@mailboxworks.com