

All 4C Units shall be designed such that they are in compliance with the following installation requirements:

- At least one customer compartment shall be positioned less than 48 inches from the finished floor
- No parcel locker compartment (interior bottom shelf) shall be positioned less than 15 inches from the finished floor
- No patron (tenant) lock shall be located 67 inches above the finished floor
- No customer compartment (interior bottom shelf) shall be positioned less than 28 inches from the finished floor
- The USPS Arrow lock shall be located between 36 and 48 inches above the finished floor

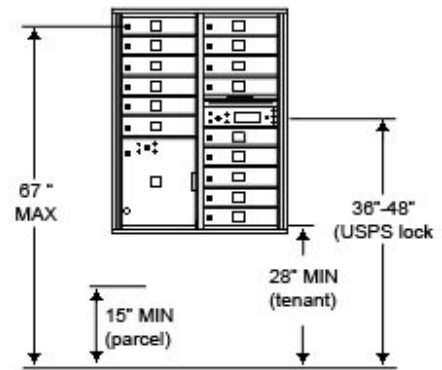

This is to meet ADA compliance -- the USPS 4C Standard includes a requirement to meet Americans with Disabilities Act (ADA).



www.MailboxWorks.com
800.824.9985
info@mailboxworks.com

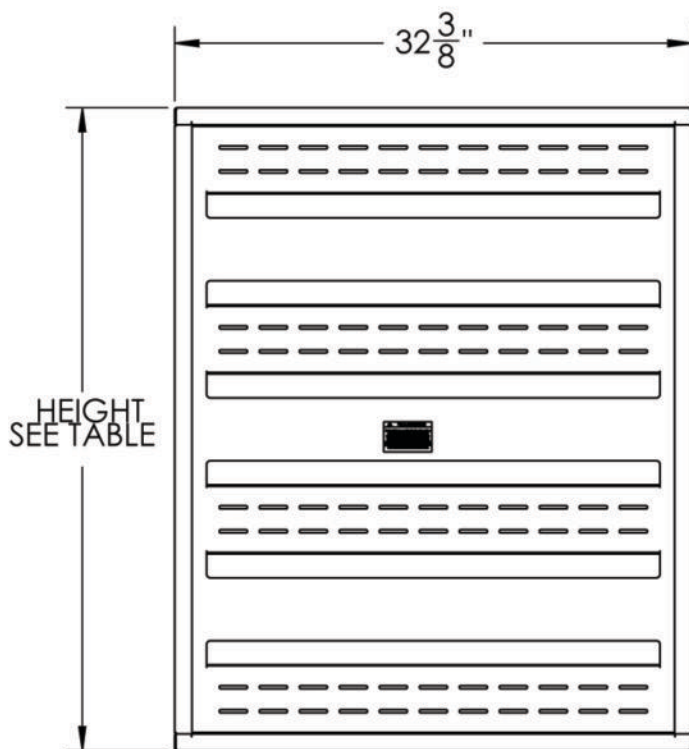

FRONT VIEW
DOUBLE COLUMN

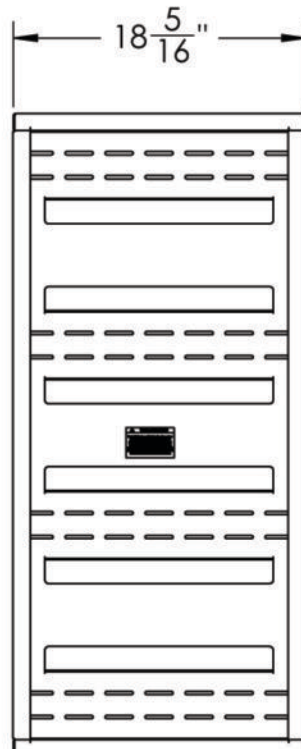

FRONT VIEW
SINGLE COLUMN

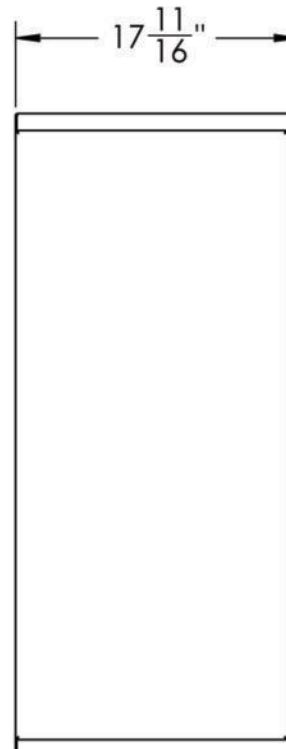

SIDE VIEW

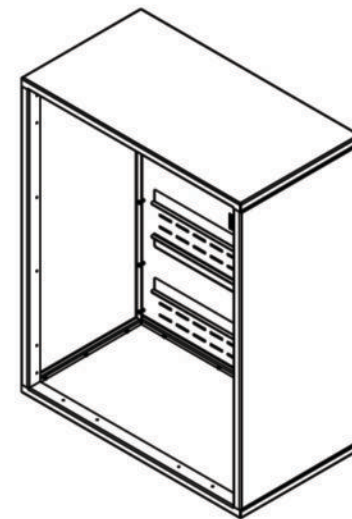

4C COLLAR

STD-4C UNIT	HEIGHT
SUITE A	40 3/16"
SUITE B	19 3/16"
SUITE C	52 7/16"
SUITE D	22 11/16"
SUITE E	29 11/16"
SUITE F	57 11/16"
SUITE G	55 15/16"



www.MailboxWorks.com

800.824.9985

info@mailboxworks.com

by Auth Florence
SURFACE MOUNT COLLAR FOR
versatile 4C mailbox suites

MODEL: 4C COLLAR	REV:
SCALE: 1:12	DATE DRAWN: 05/21/2007
DRAWING NUMBER: 4CCOLLARCS	DRAWN BY: OSW